

## POD MAX

POD MAX is a negotiation room perfect for 6-8 persons. Its pleasant sound environment guarantees the most efficient premise for bigger meetings and negotiations. It is equipped with a motion detector and a control unit that automatically starts the ventilation and lighting when you walk into the POD room. When the space is not in use, the control unit shuts down the ventilation and power.

### TECHNICAL INFORMATION

Three electrical sockets + data outlet on the back wall.  
 Three electrical sockets on the door sidewall.  
 POD electricity connection from the ceiling or floor.  
 The length of the electric cord is 3 m.  
 Automated electric ventilation with speed mode, lights with electronic motion sensor, and separate electronic control units on the wall.  
 Glass window includes the INTO stripe window taping.  
 Installation wheels included.

### MATERIAL DESCRIPTION

Melamine or veneered frame.  
 Painted MDF door and door side panels.  
 Door handle with satin-finished stainless steel.  
 Laminated acoustic safety glass windows 10 mm.  
 Acoustic panels on the ceiling.  
 Floor and back wall coated with carpet.

POD surface options:	White NCS S 0500-N Dark grey NCS S 7500-N Pine American Oak Black Oak
POD inside color:	White NCS S 0500-N
Carpet options:	Fletco Ex-dono quartet
Ceiling acoustic panel:	GABRIEL - Soul
Door color options:	White smooth NCS S 0500-N American Oak Clear glass 10 mm

### MEASUREMENTS

W3400 x D5000 x H2220 mm  
 Door 9 x 21

Inner dimensions  
 3200 x D4600 x H2040 mm

POD MAX LEFT

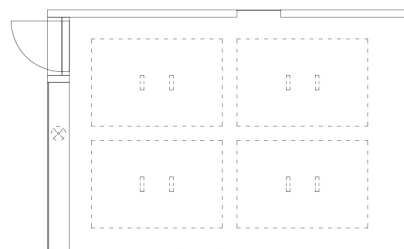

POD MAX RIGHT

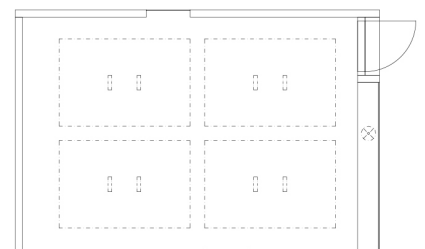

## SURFACE FINISHES FOR POD ROOMS

### STANDARD PRICE, CATEGORY 1

Melamine color options

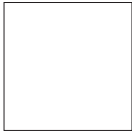

NCS S 0500-N



NCS S 7500-N

### PRICE CATEGORY 2

Veneer material options



Pine

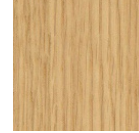

American oak



Black oak

## SURFACE FINISHES FOR DOOR & DOOR SIDE PANELS

### STANDARD PRICE, CATEGORY 1



NCS S 0500-N

### PRICE CATEGORY 2

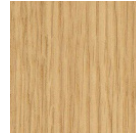

American oak



Clear glass 10 mm

comes with white door panels

## CARPETS FOR POD ROOMS: EX-DONO QUARTET FROM FLETCO | STANDARD PRICE, CATEGORY 1

Composition: Polyester non woven  
Static electrical propensity: Antistatic  
Impact sound reduction: 25 dB  
Classification for use: Commercial / heavy use  
Fire resistant: Yes



393300



393340



393350

Ask for more colors: [sales@intoconcept.com](mailto:sales@intoconcept.com)

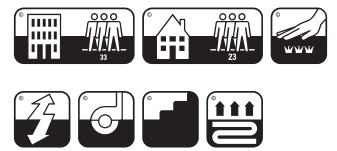
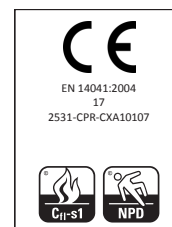

## CEILING ACOUSTIC PANEL FABRIC: SOUL FROM GABRIEL | STANDARD PRICE, CATEGORY 1

Composition: 100% wool  
Lightfastness: 5-7  
Rubbing fastness: 4/wet, 4-5/dry  
Sustainability: Complies with STANDARD 100 by OEKO-TEX  
Meet Möbelfakta requirements  
Cleaning: regular vacuum cleaning  
Fire resistant: Yes (S 476 Part 7, class 1 ÖNORM B 3825-B1-3800-Q1 UK)



66104



67039



68131



64086



62059



61196

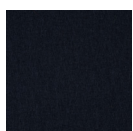

60182

